

PLAT BOOK

OF

JOHNSON COUNTY, MISSOURI

St. Louis Public Library
REFERENCE DEPT.

Published by

W.W.HIXSON & CO.

Rockford, Illinois

912.778

PLAT

PLAT
MAP
FILE

912.778

PLAT

JOHNSON COUNTY MISSOURI

MADE BY
W. W. HARRIS & CO. ST. LOUIS, MO.

ST. LOUIS PUBLIC LIBRARY
400 N. CENTRAL ST.
ST. LOUIS, MO.

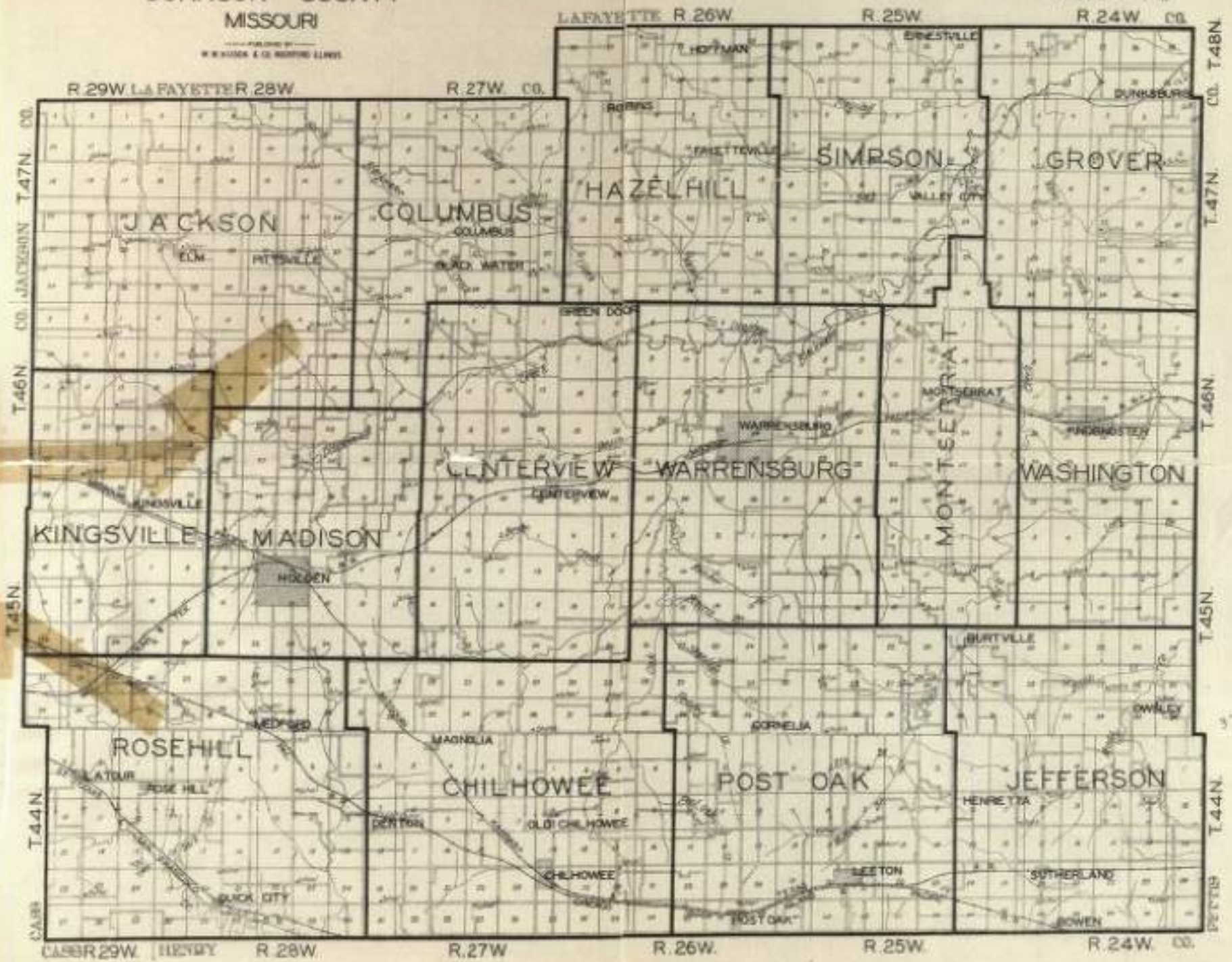

T.44N

PART OF JEFFERSON

R.24W.

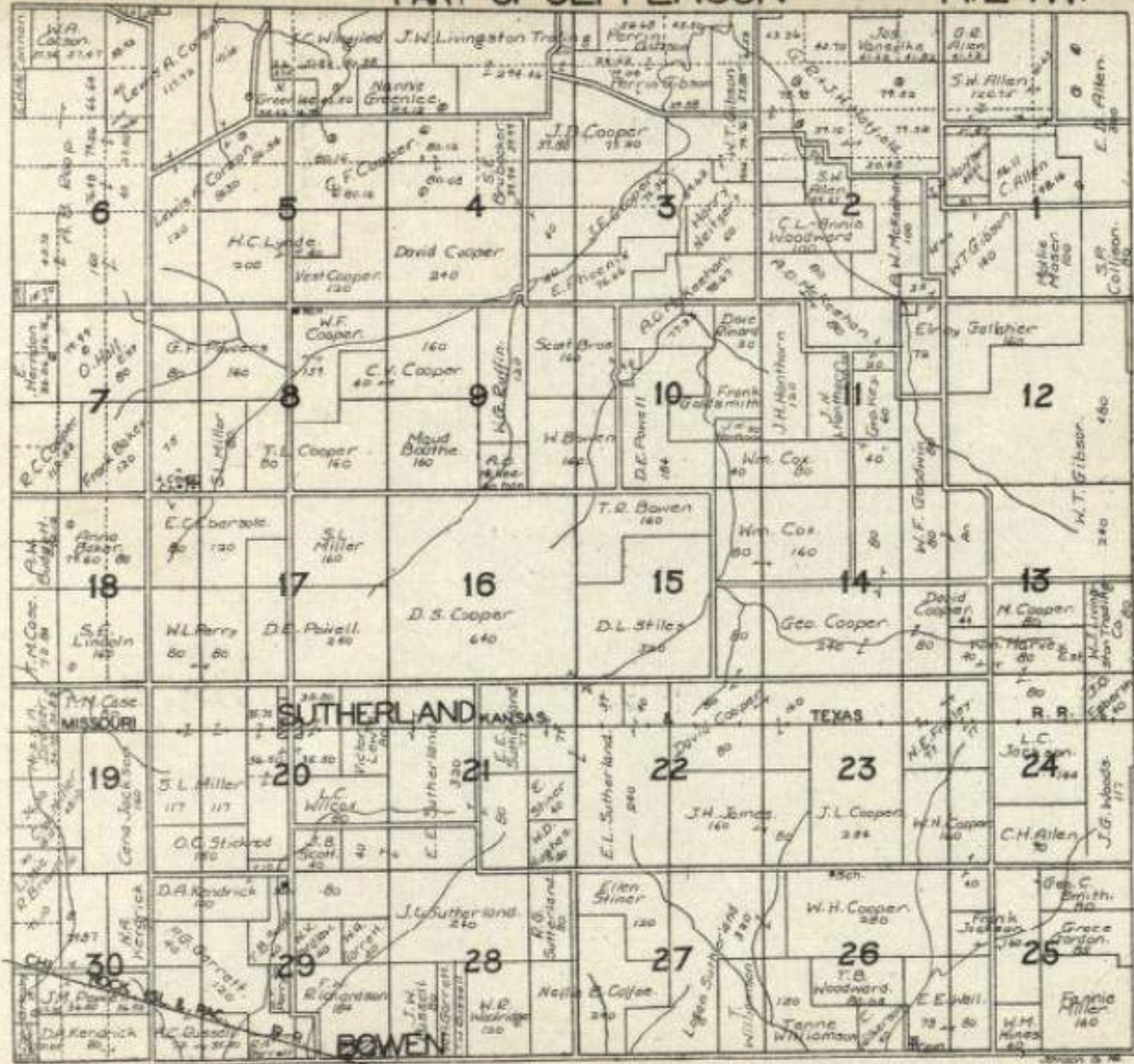

T.45N.

R.24W.

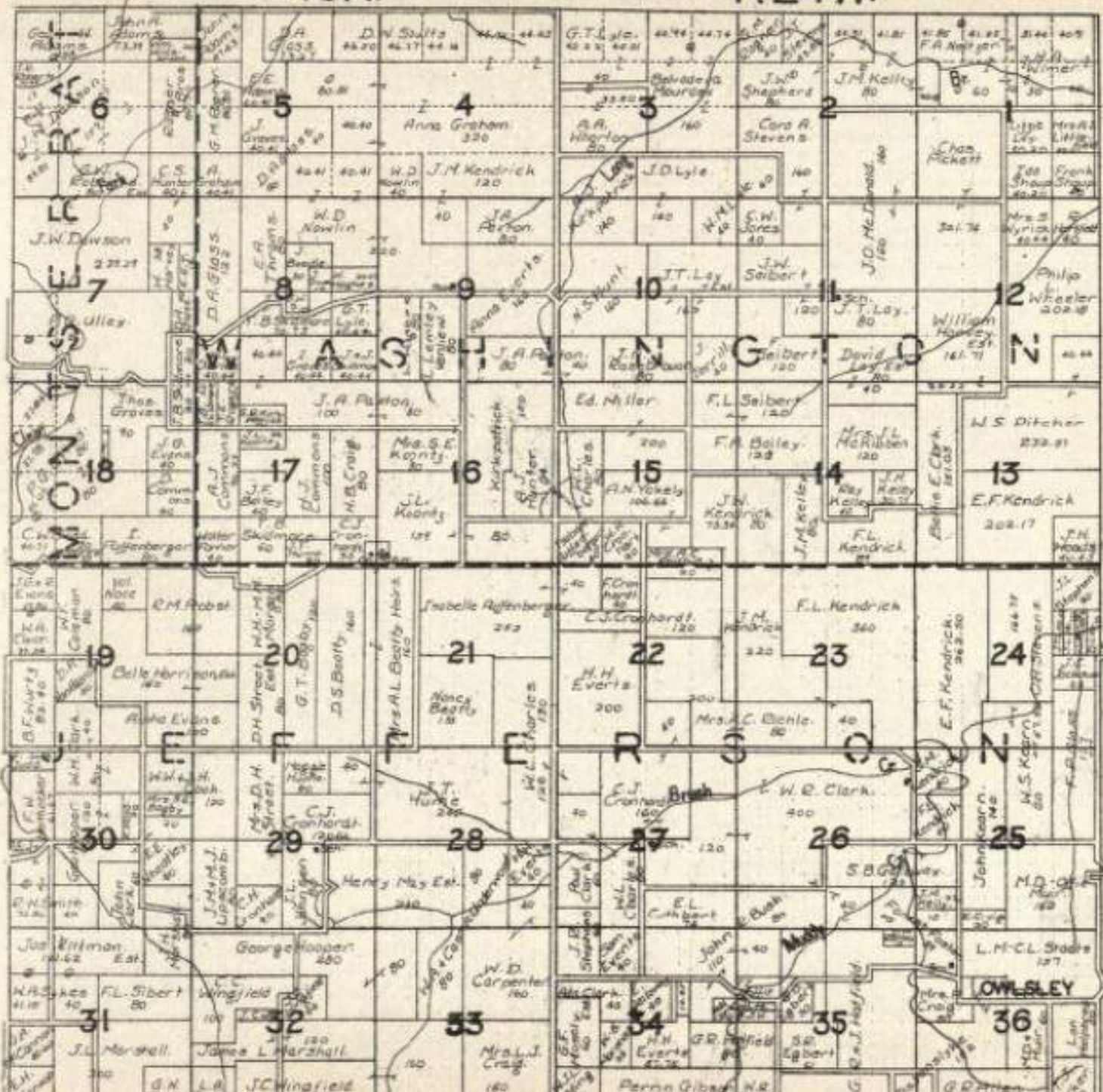

T.46N.

R.24W.

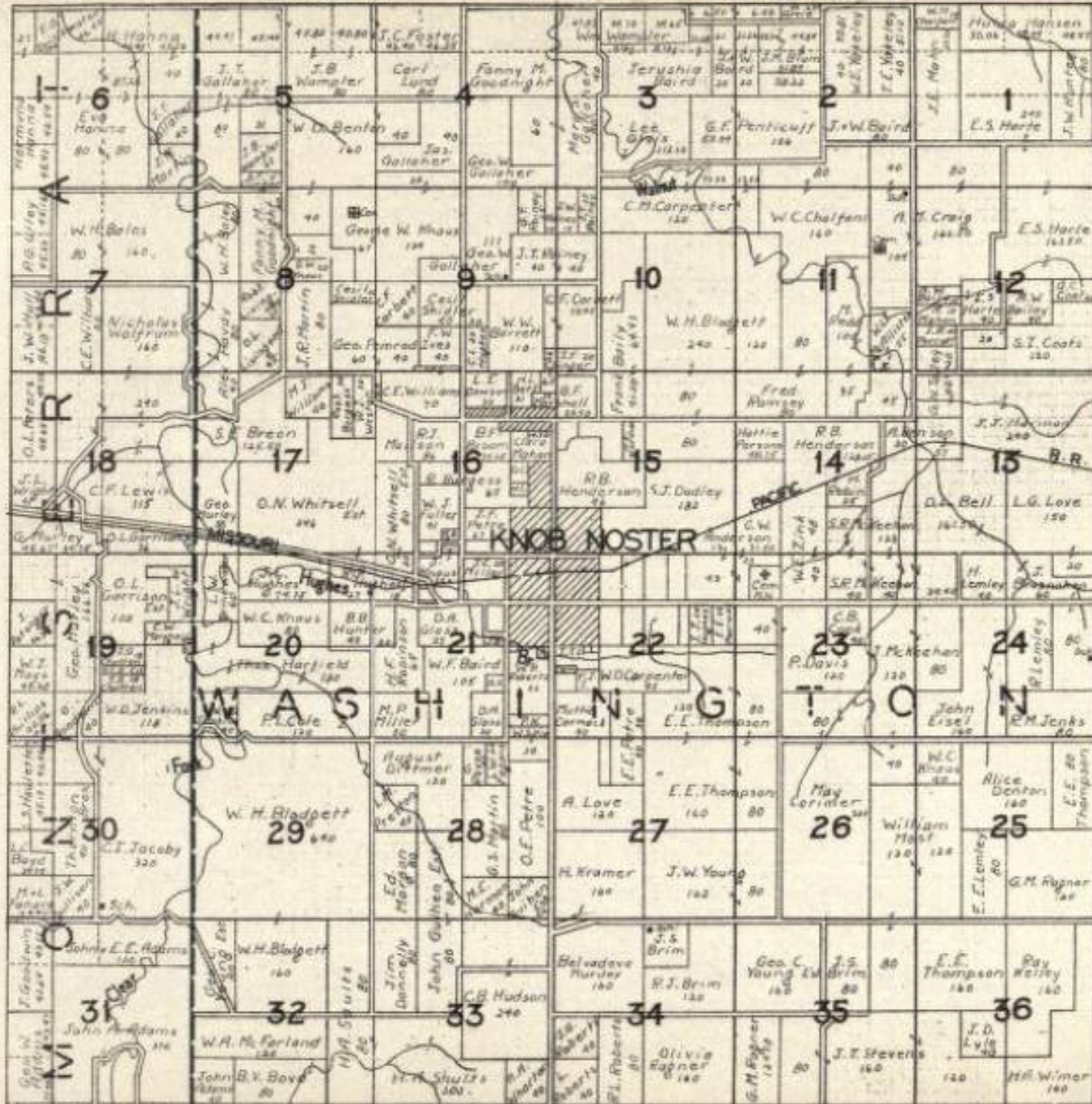

T.47N.

R.24W.

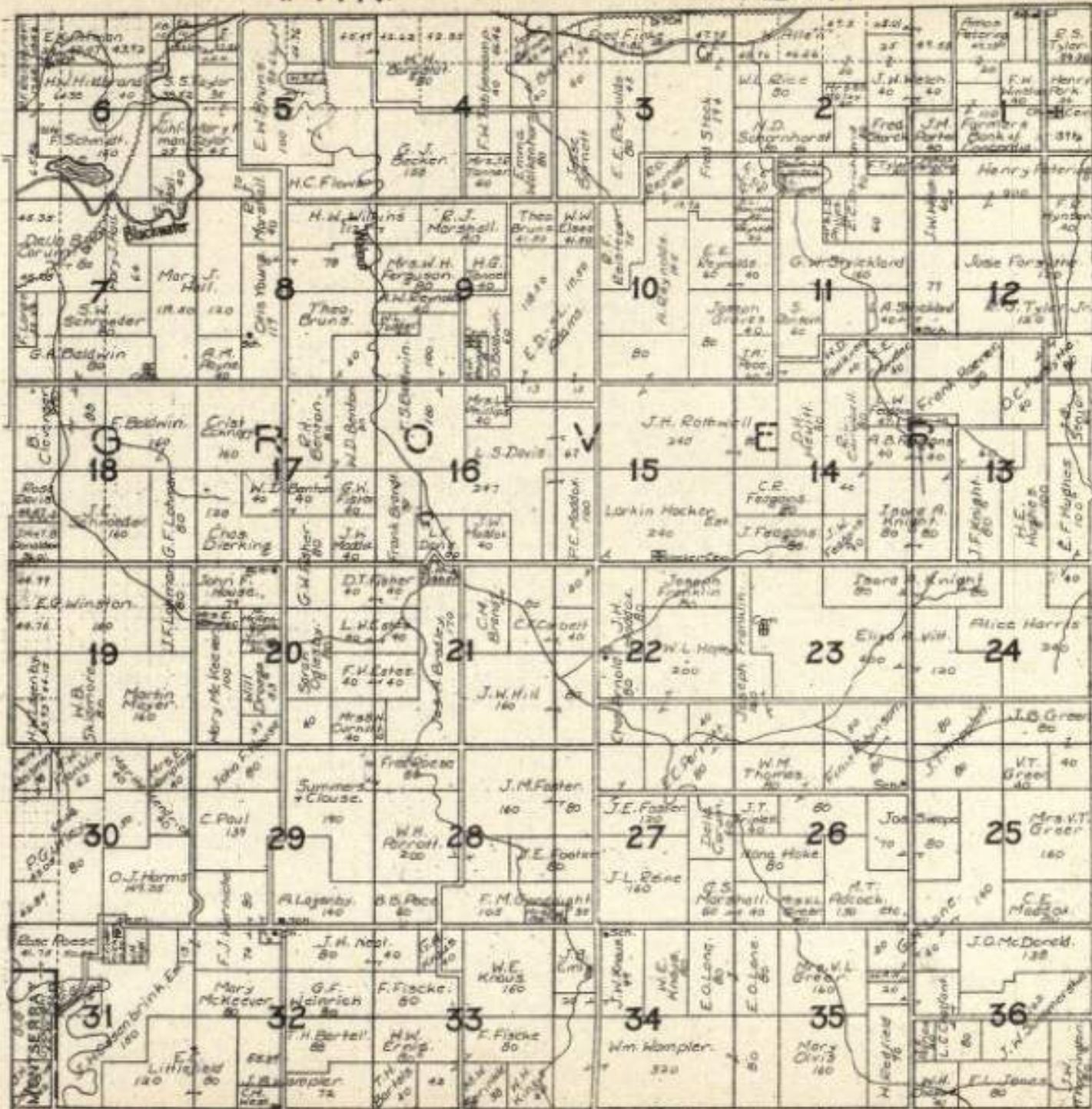

T.48N.

PART OF GROVER

R.24W.

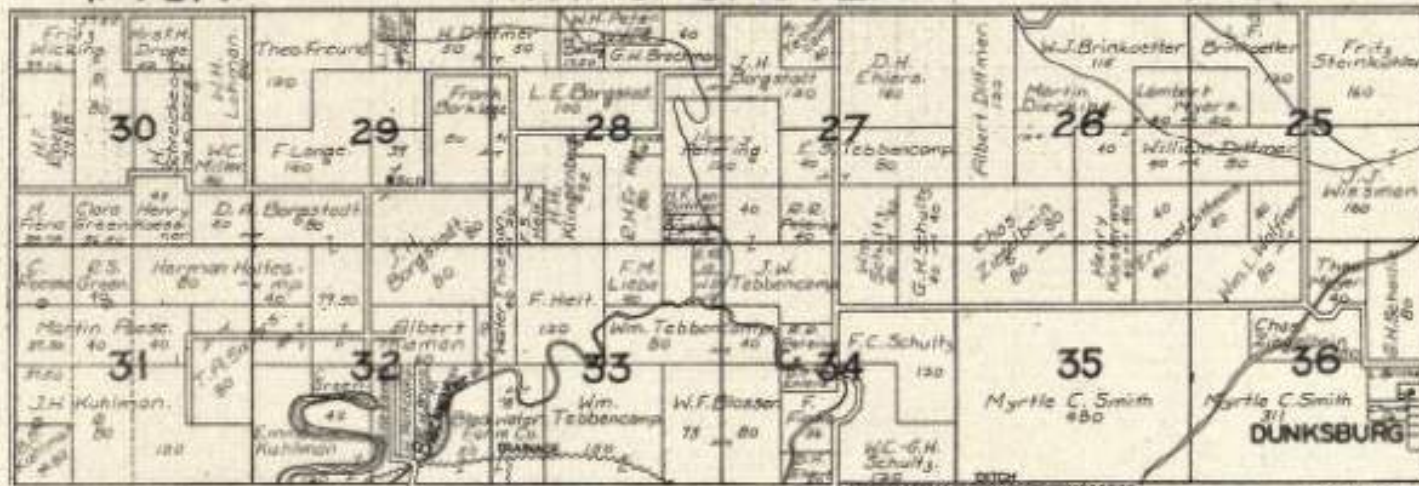

Jan. 1, 1900

T. 44N.

R. 25W.



T.45N.

R.25W.

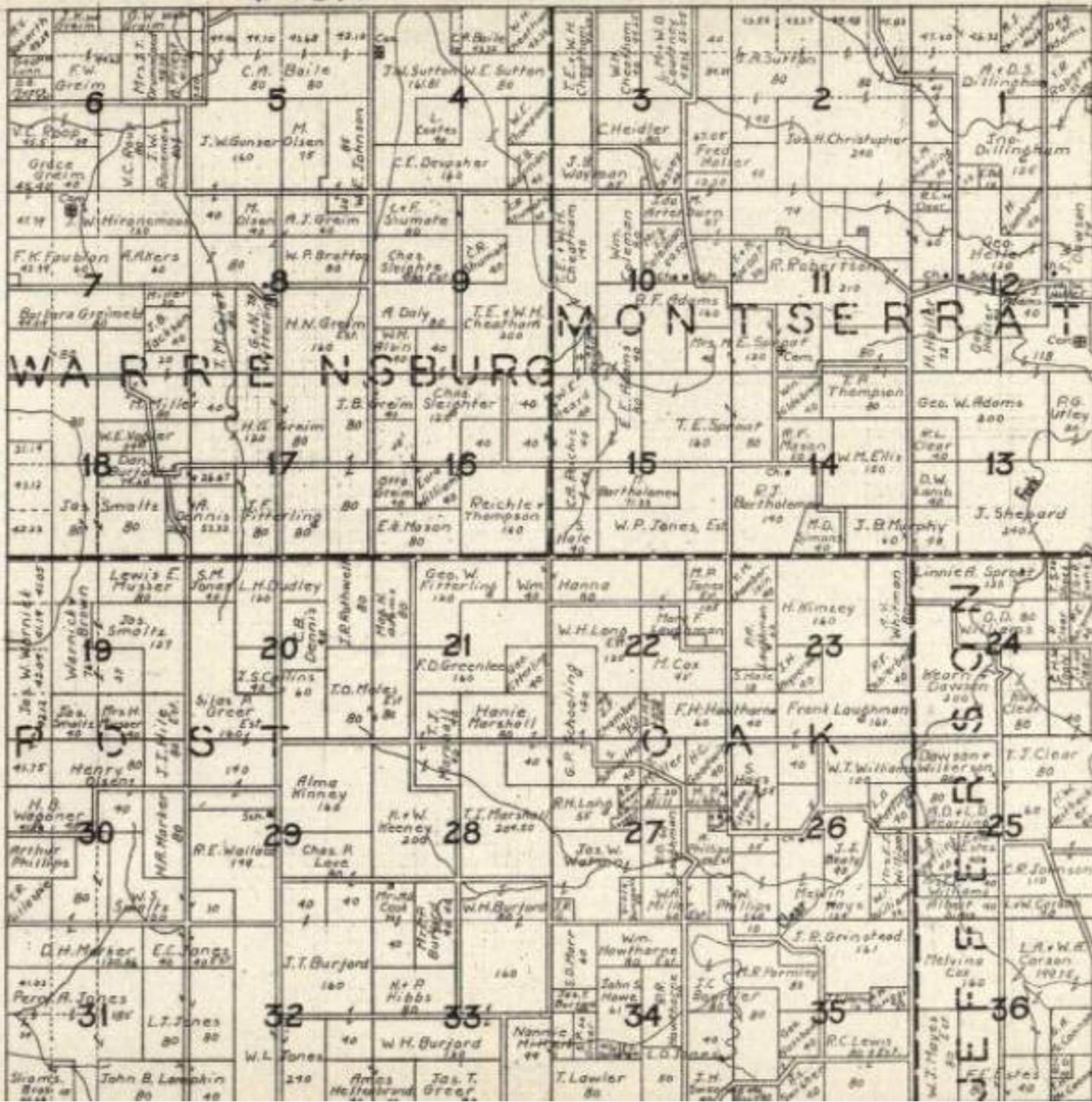

T. 46N.

R. 25W.

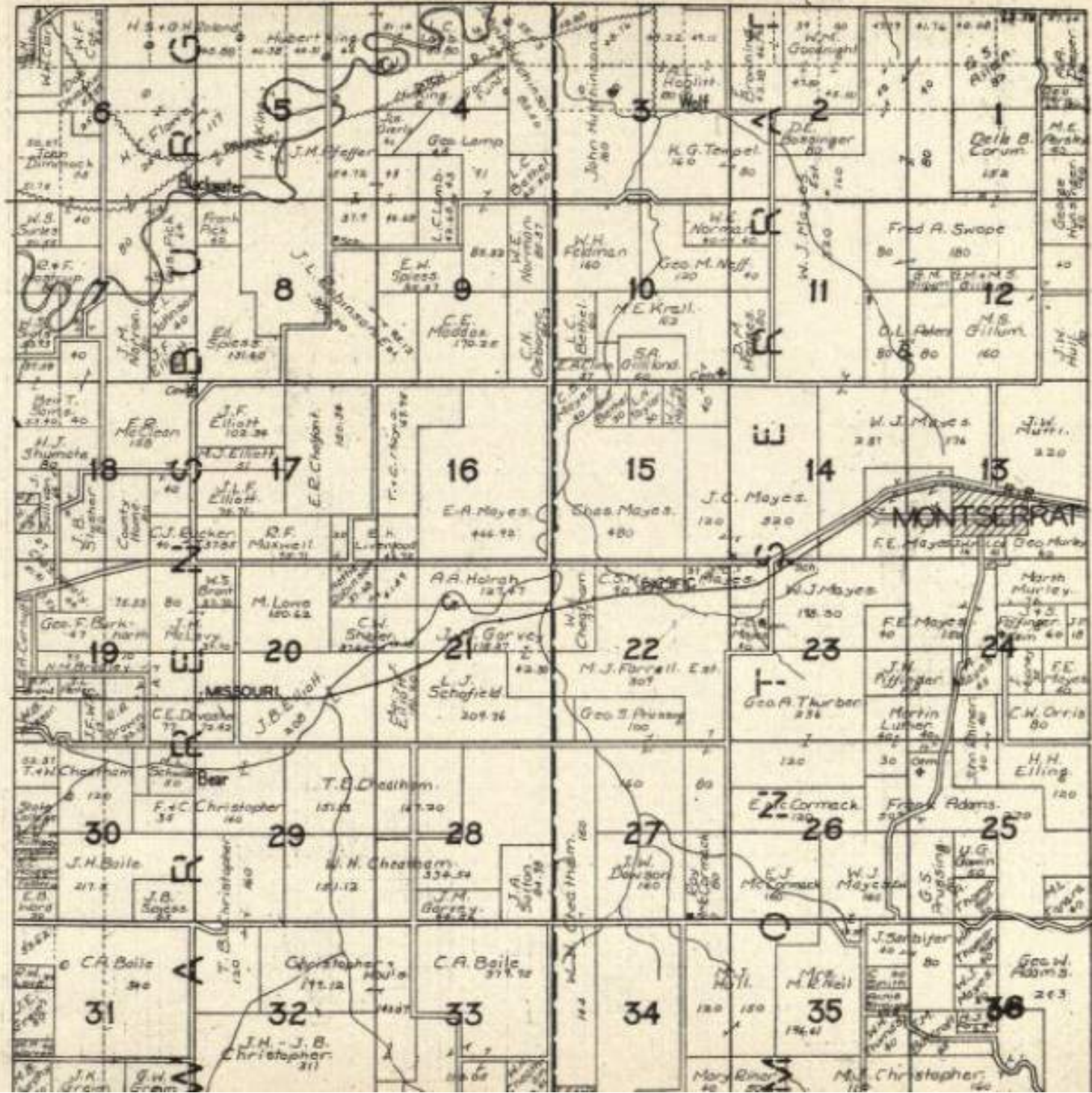

T.47N

R.25W.



T.48N.

PART OF SIMPSON

R.25W.



T.44N.

R.26W.

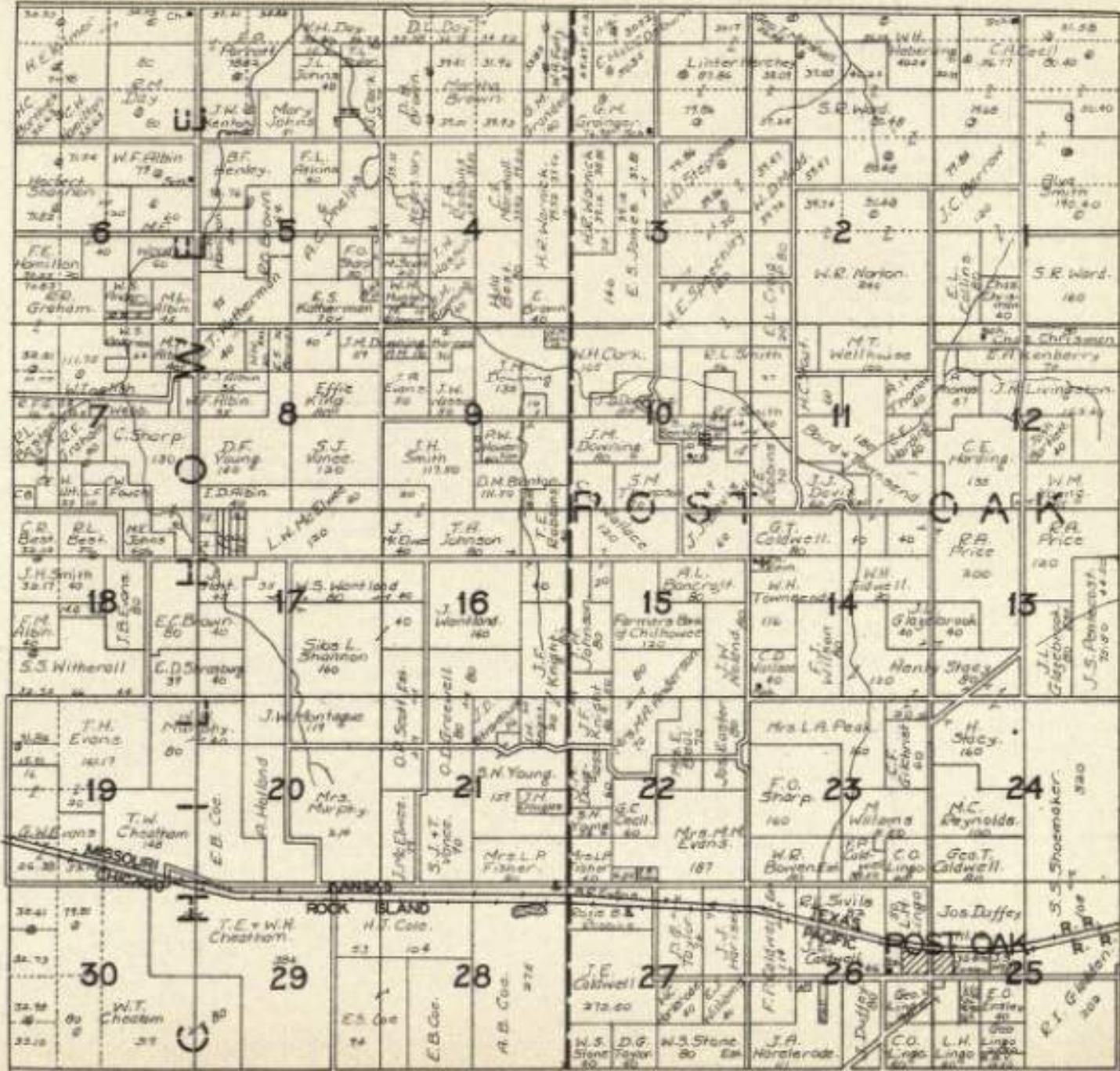

T.45N.

R.26W.



T.46N.

R.26W.

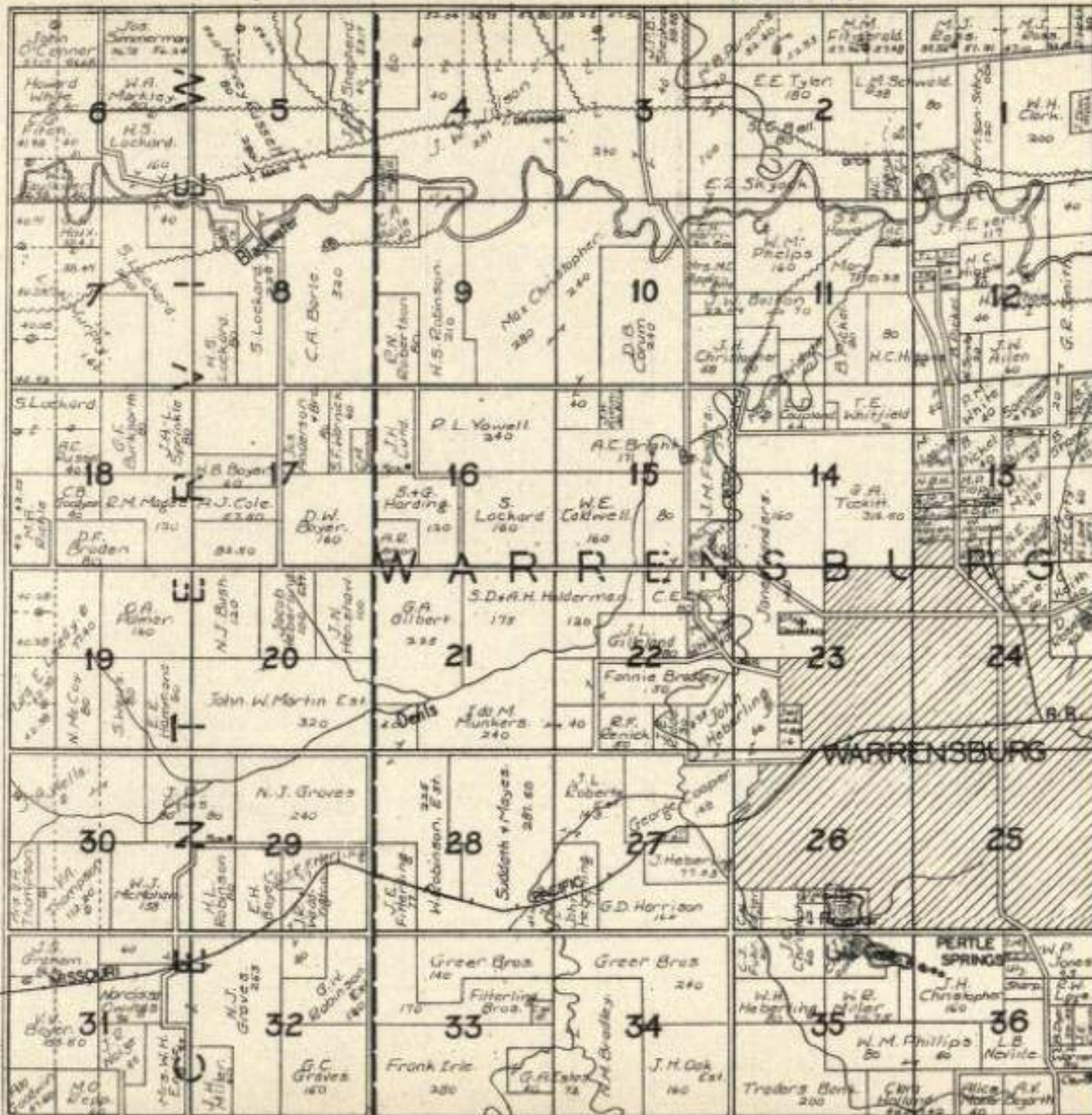

T47N.

PART OF HAZEL HILL

R.26W.

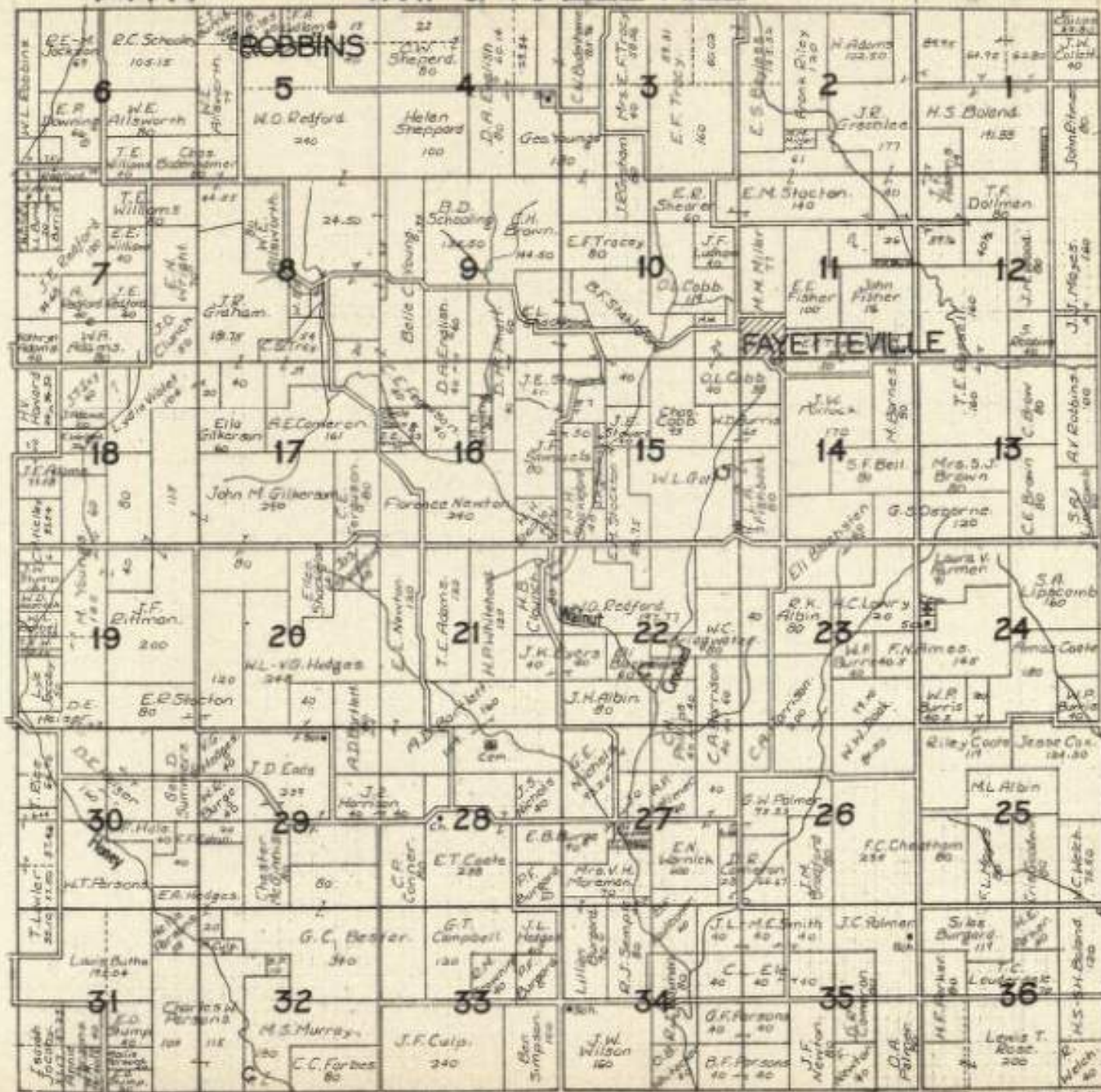

T.48N.

PART OF HAZEL HILL

R.26W.



January 20, 1900

T.44N.

PART OF CHILHOWEE

R.27W.

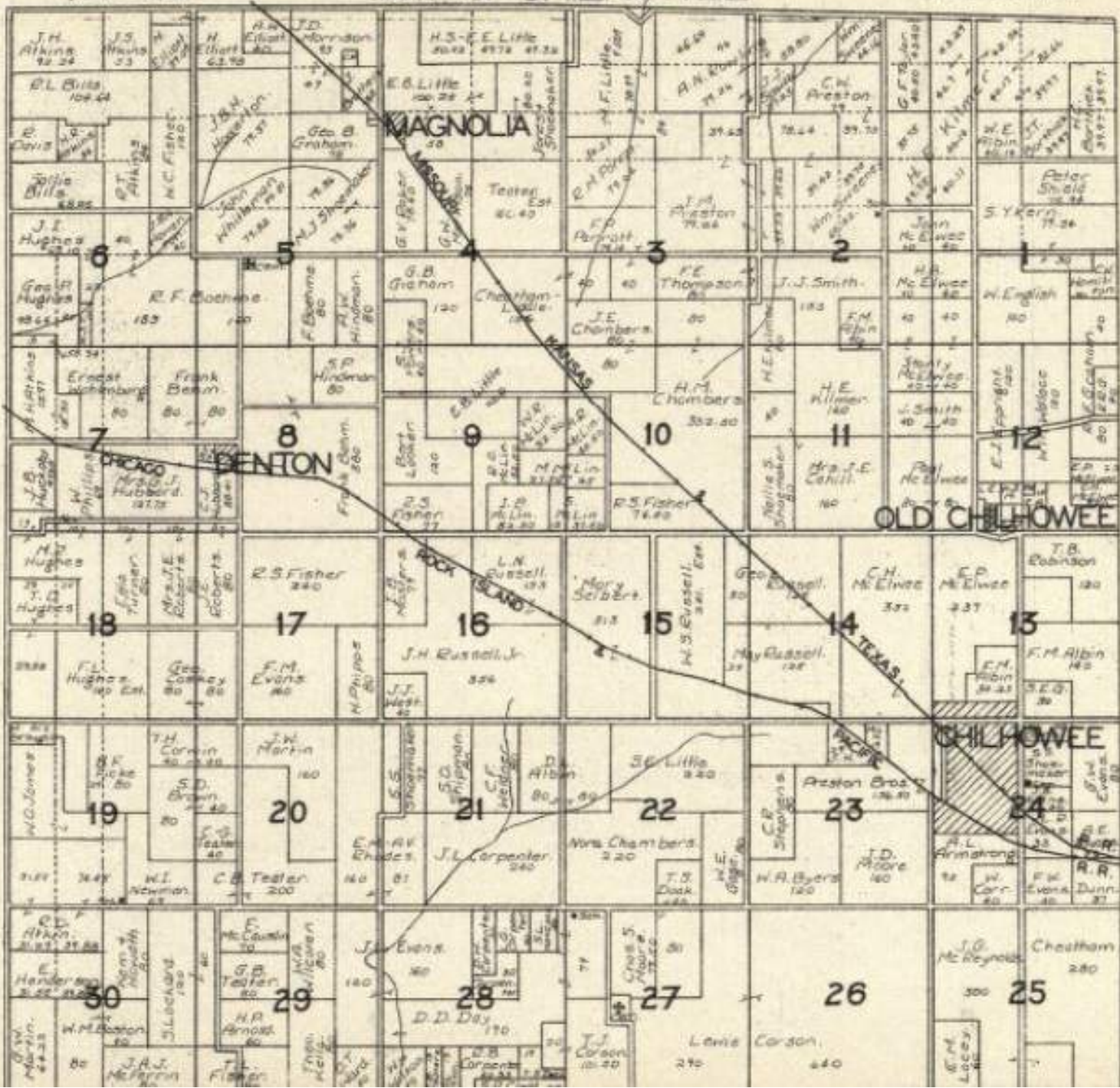

T. 45N.

R. 27W.

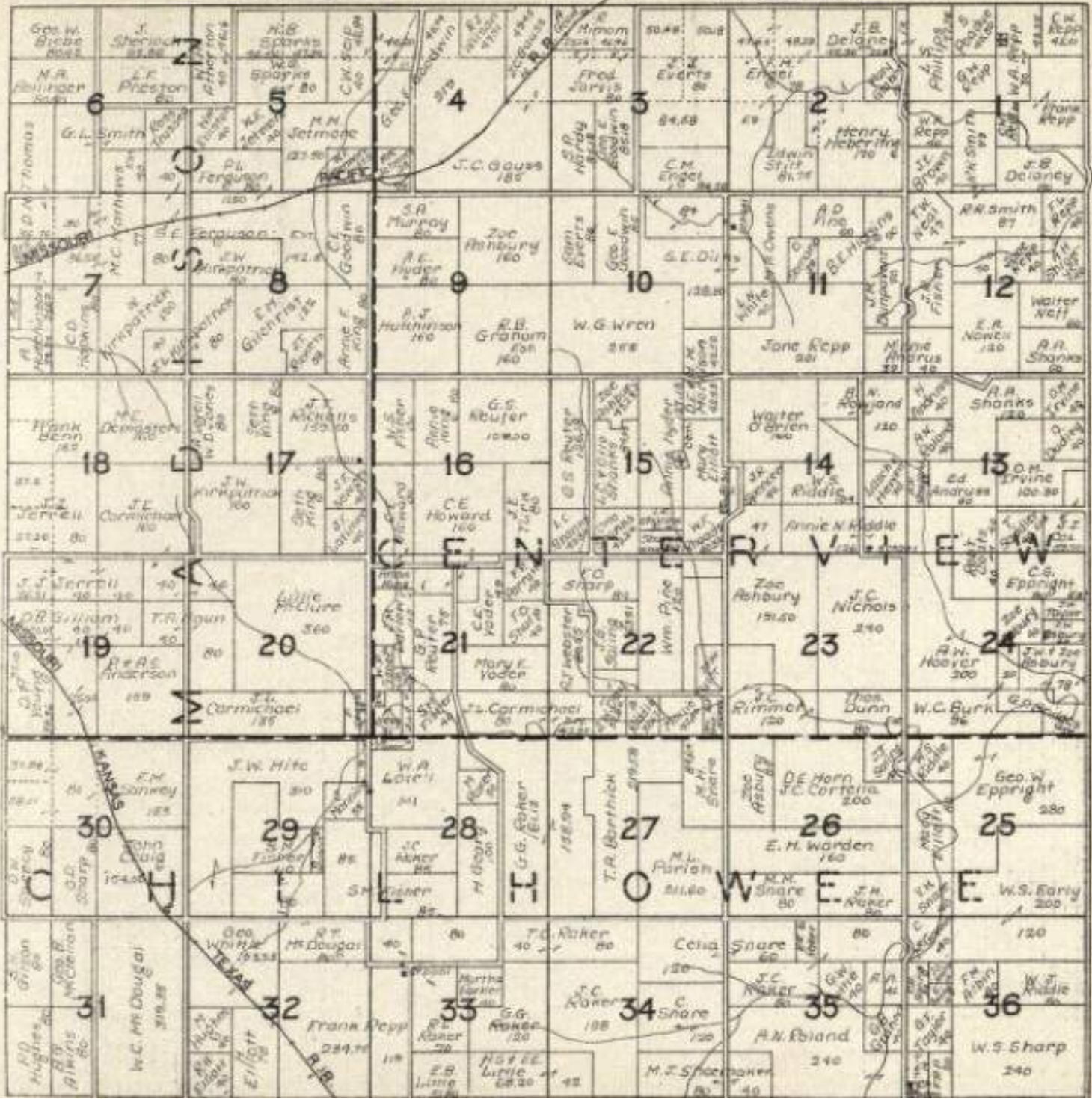

T. 46N.

R. 27W.

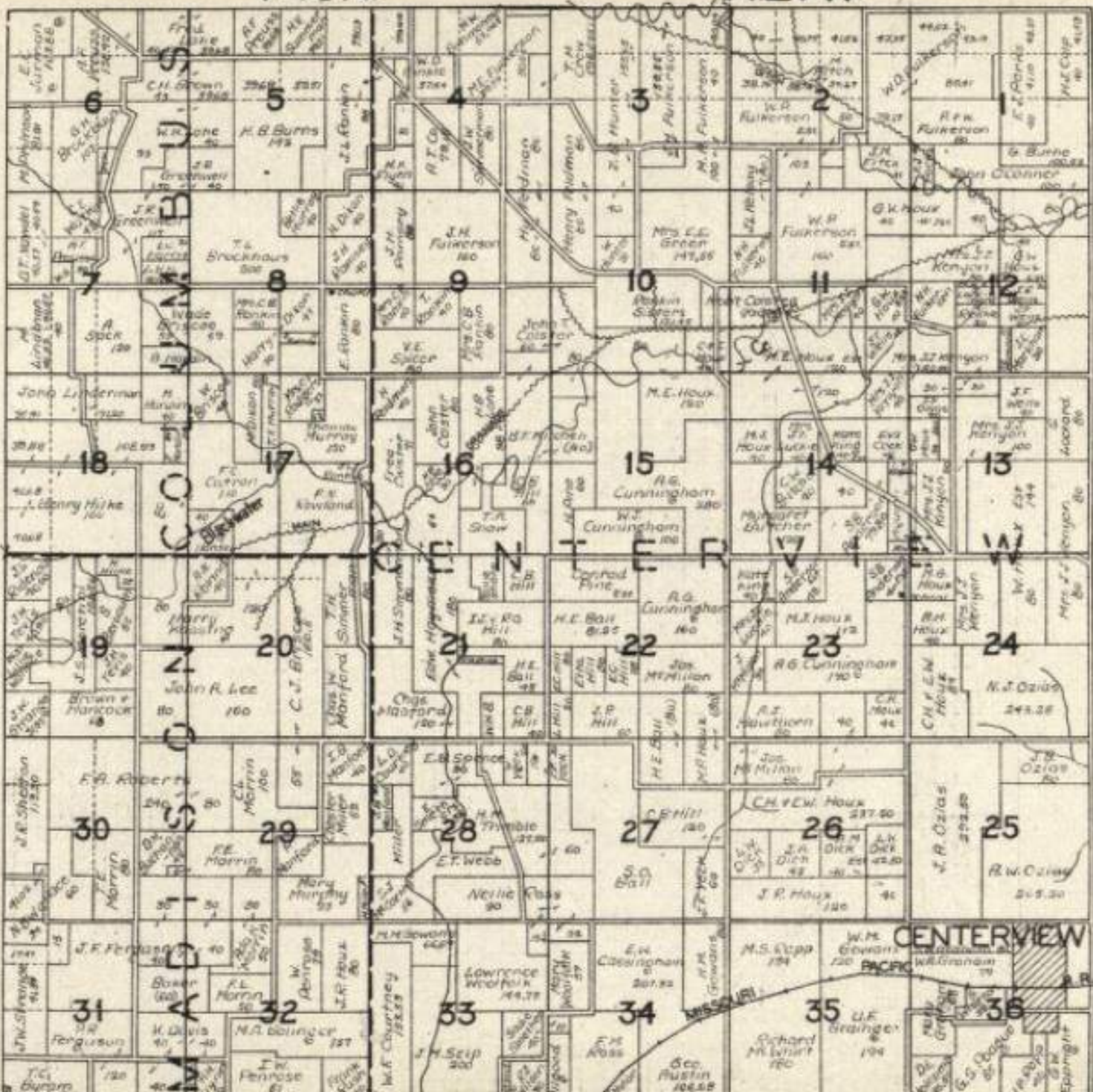

T.47N.

PART OF COLUMBUS

R.27W.



T.44N.

PART OF ROSE HILL

R.28W.

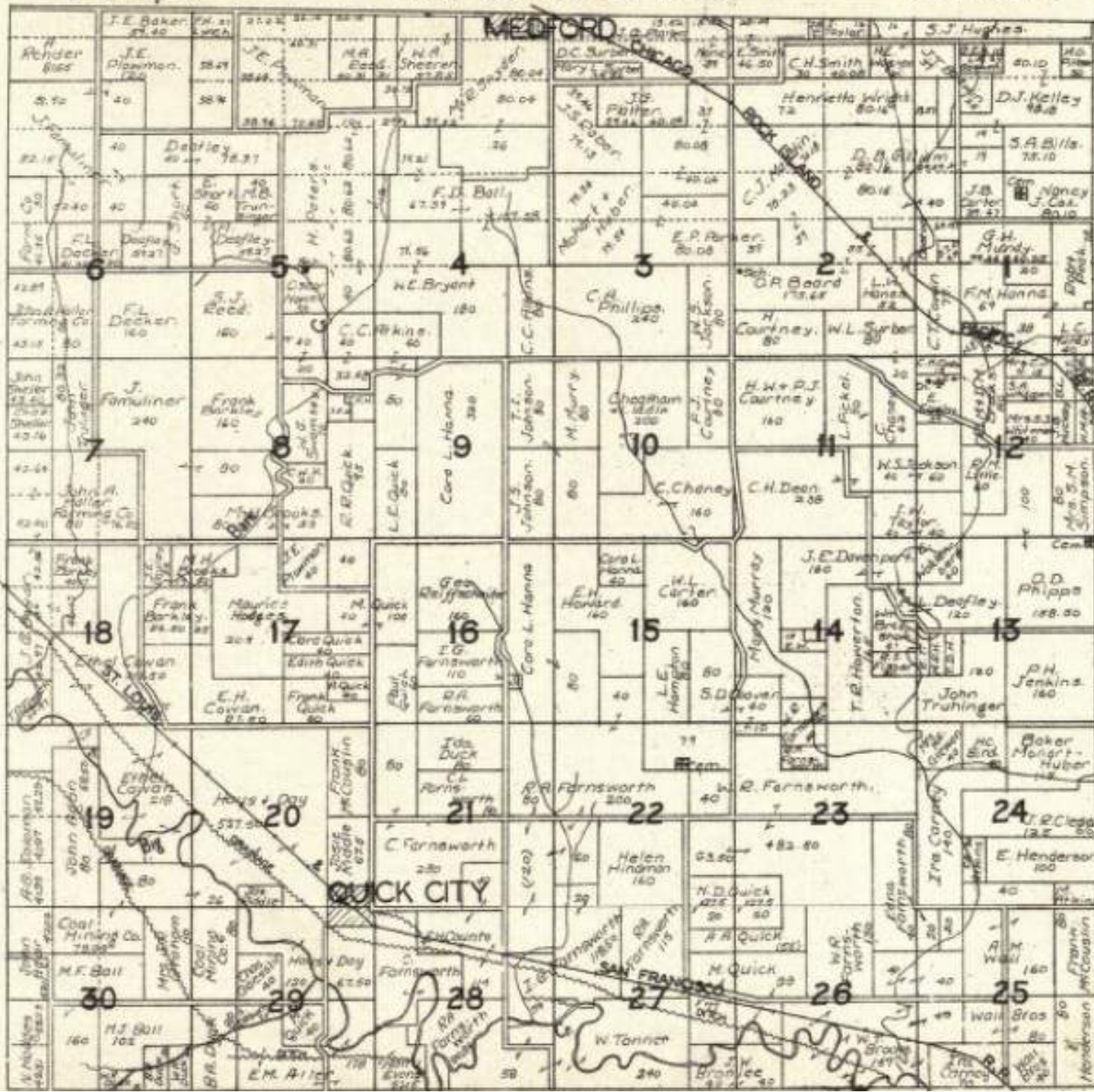

T.45N.

R.28W.

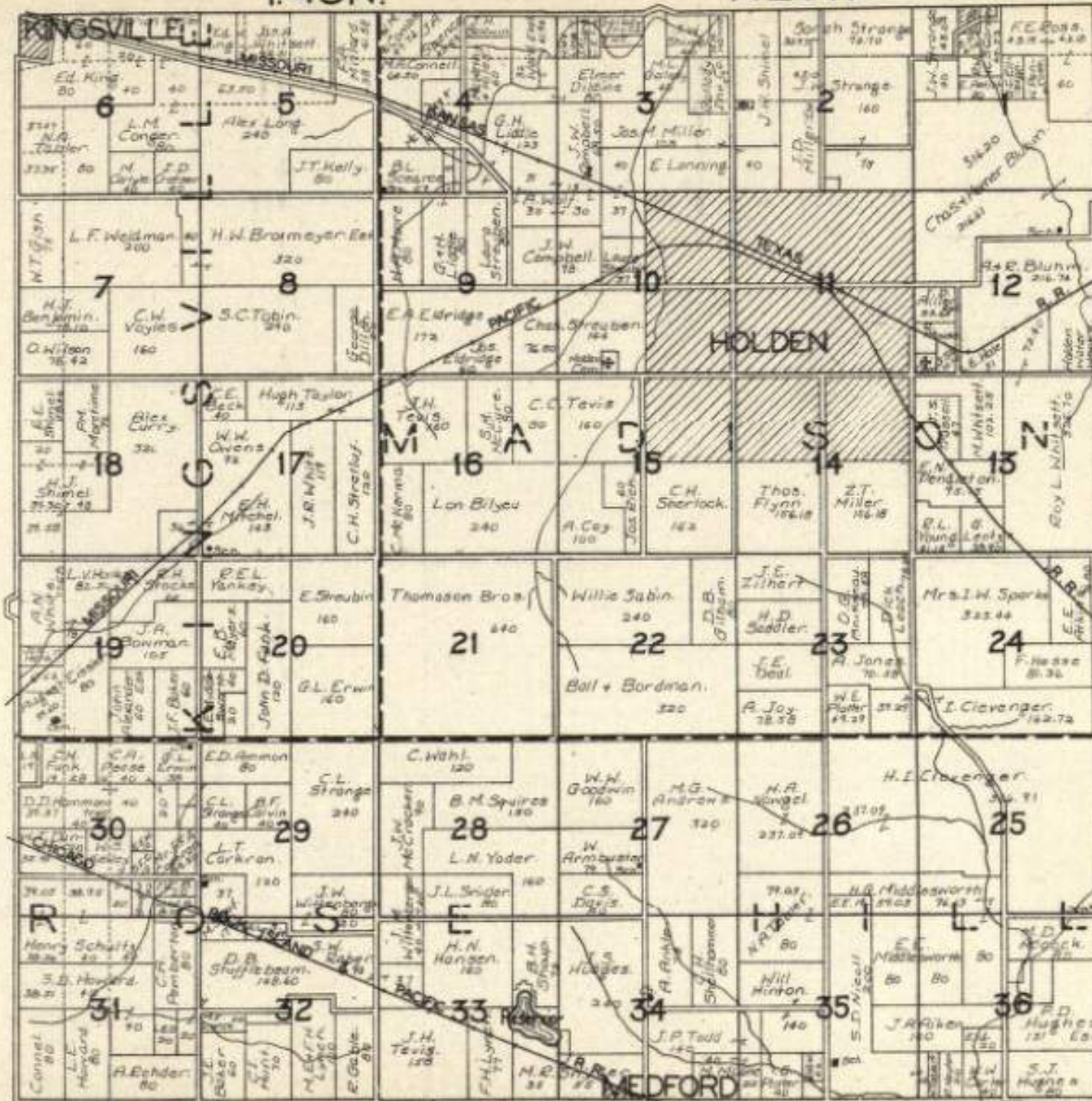

T.46N.

R.28W.

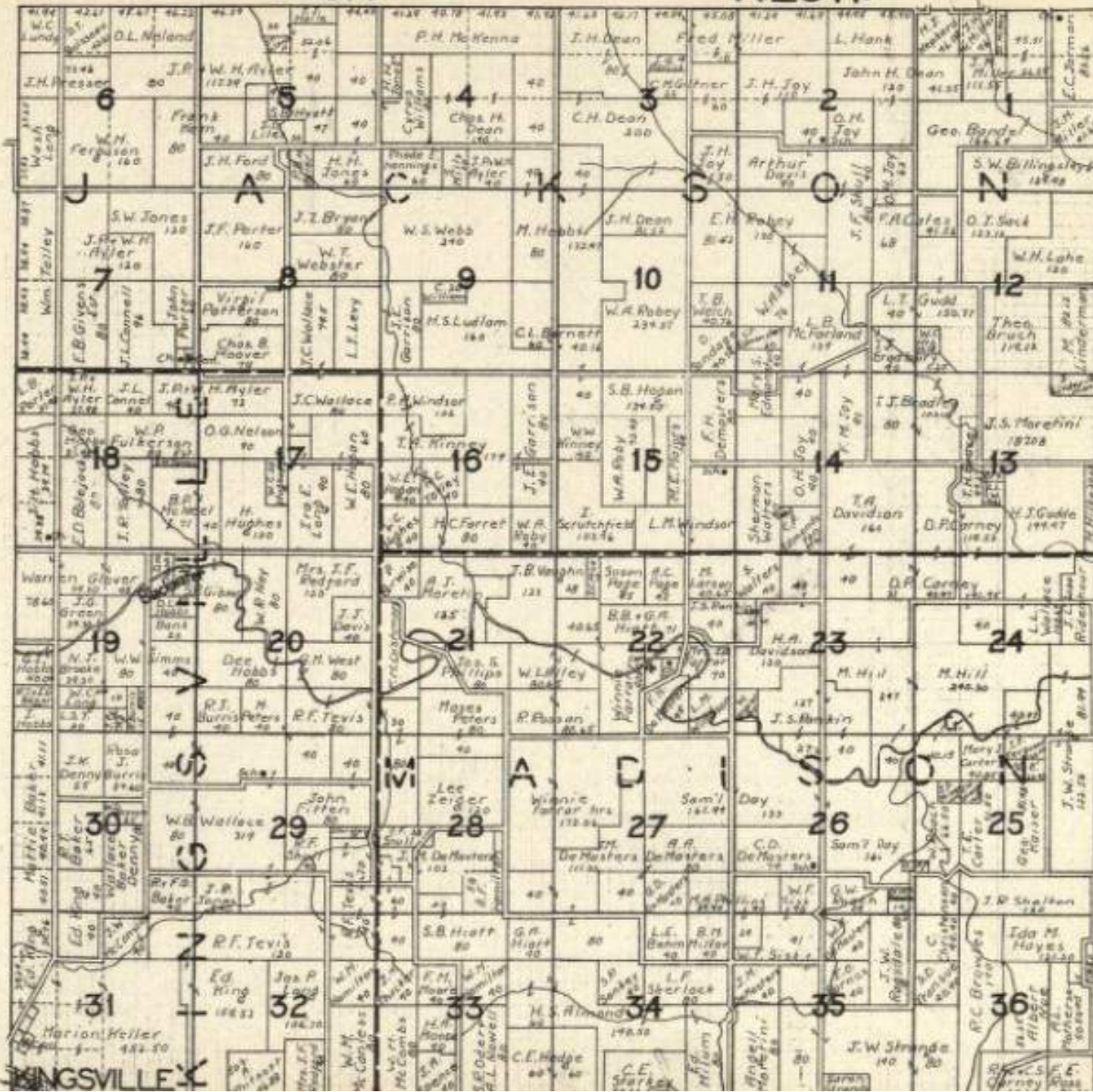

KINGSVILLE

T.47N.

PART OF JACKSON

R.28W.

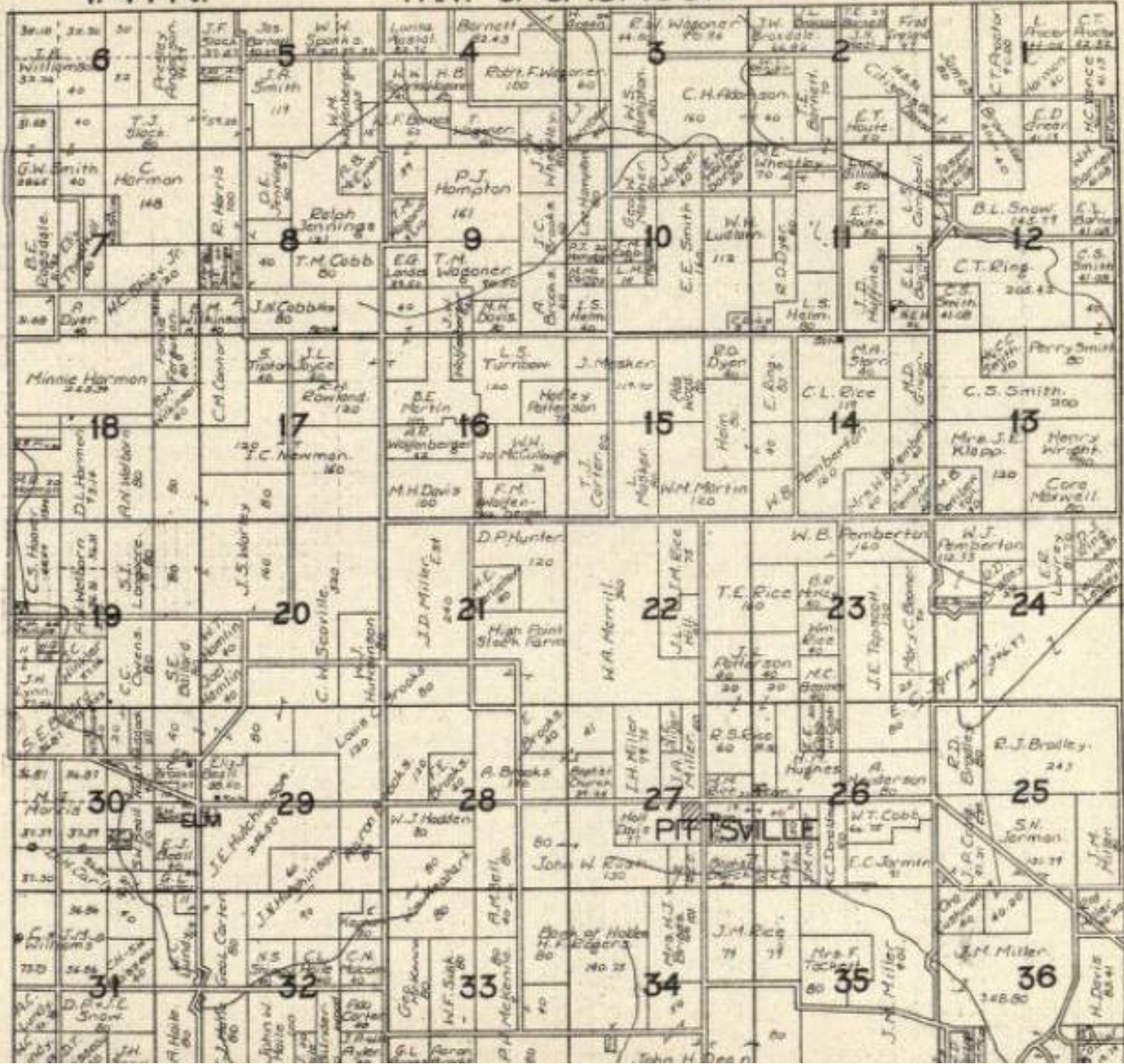

T.44N. PART OF ROSE HILL R29W.

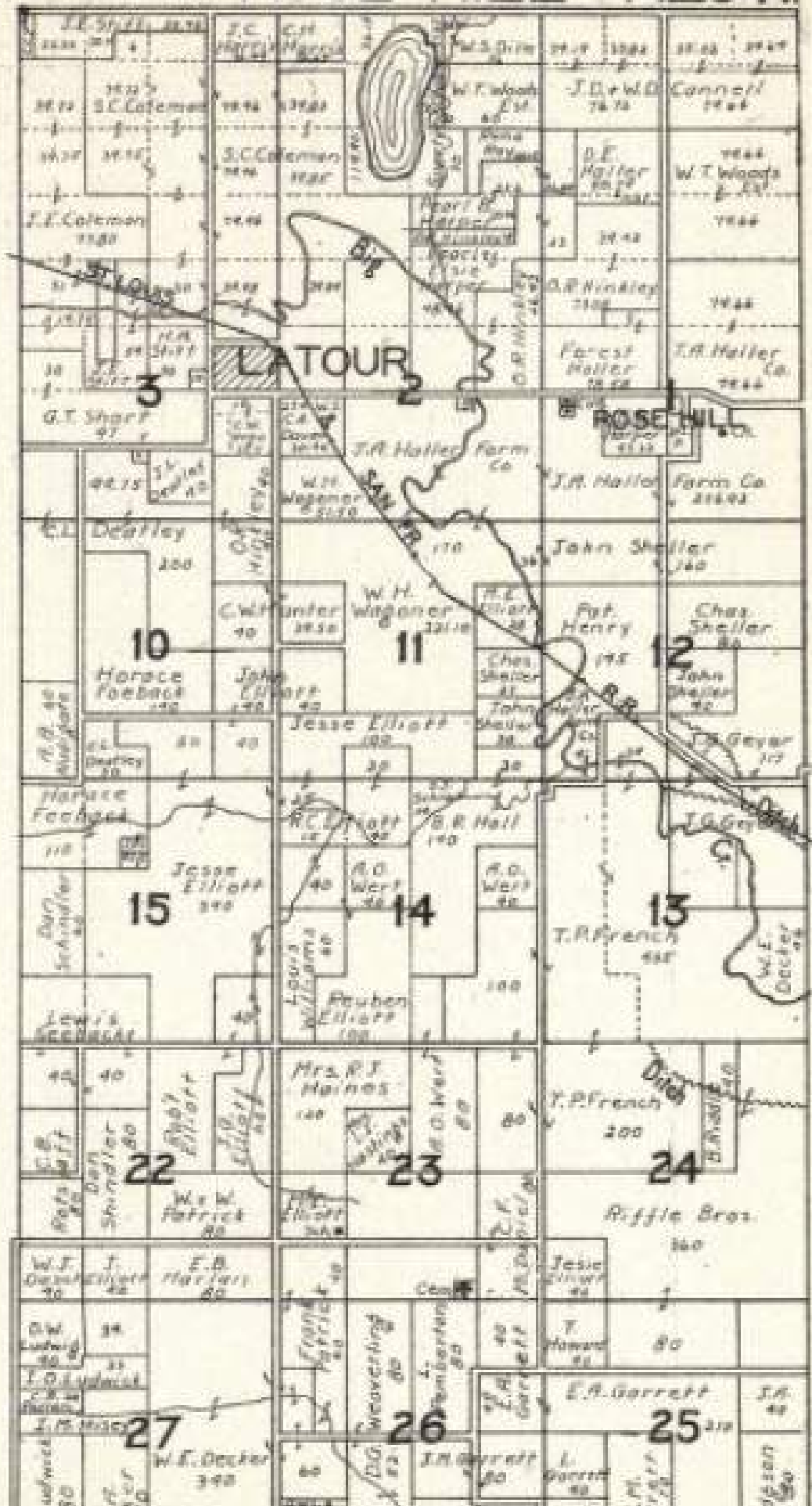

T.45N. PART OF KINGSVILLE

R.29W.

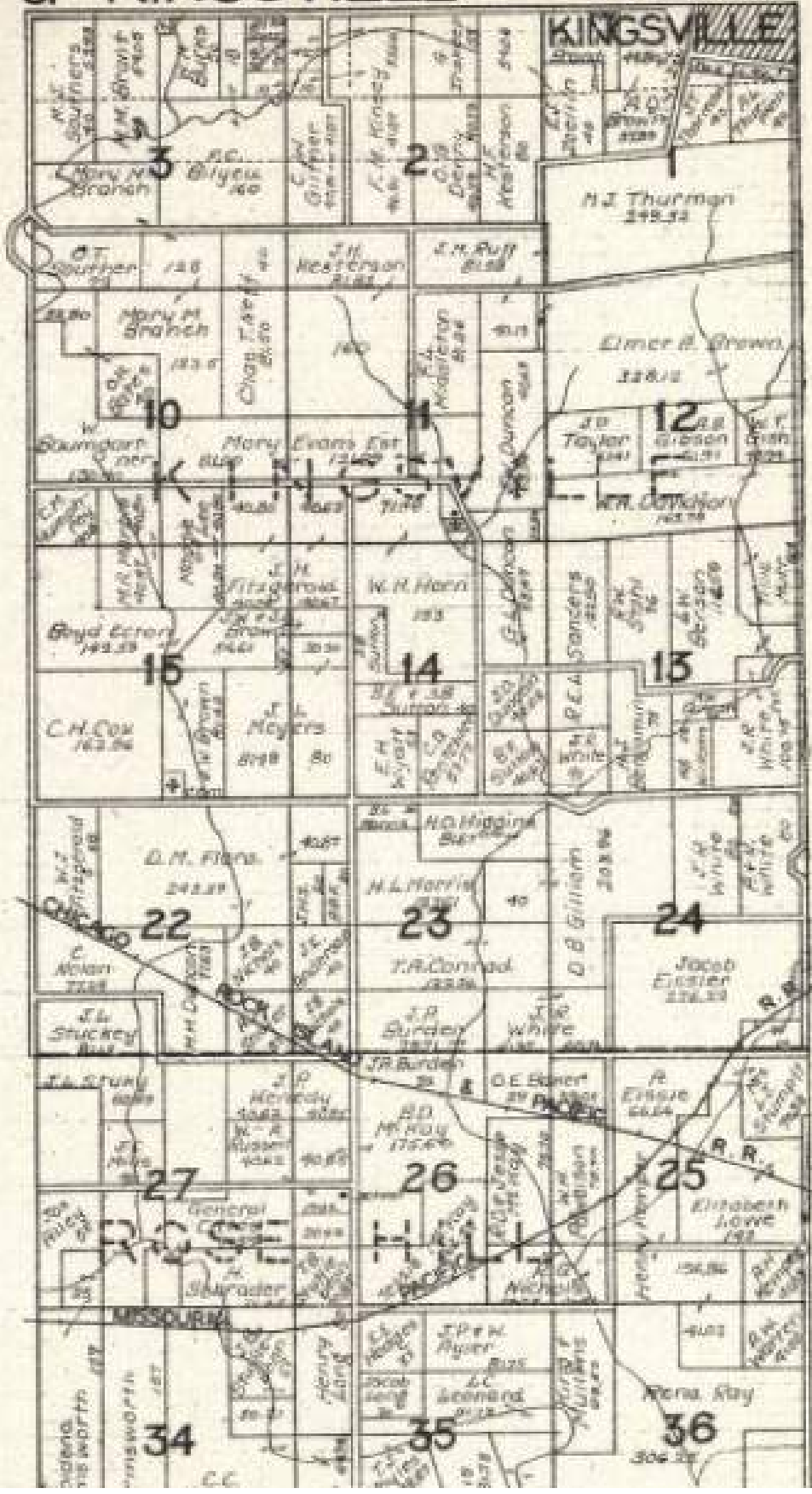

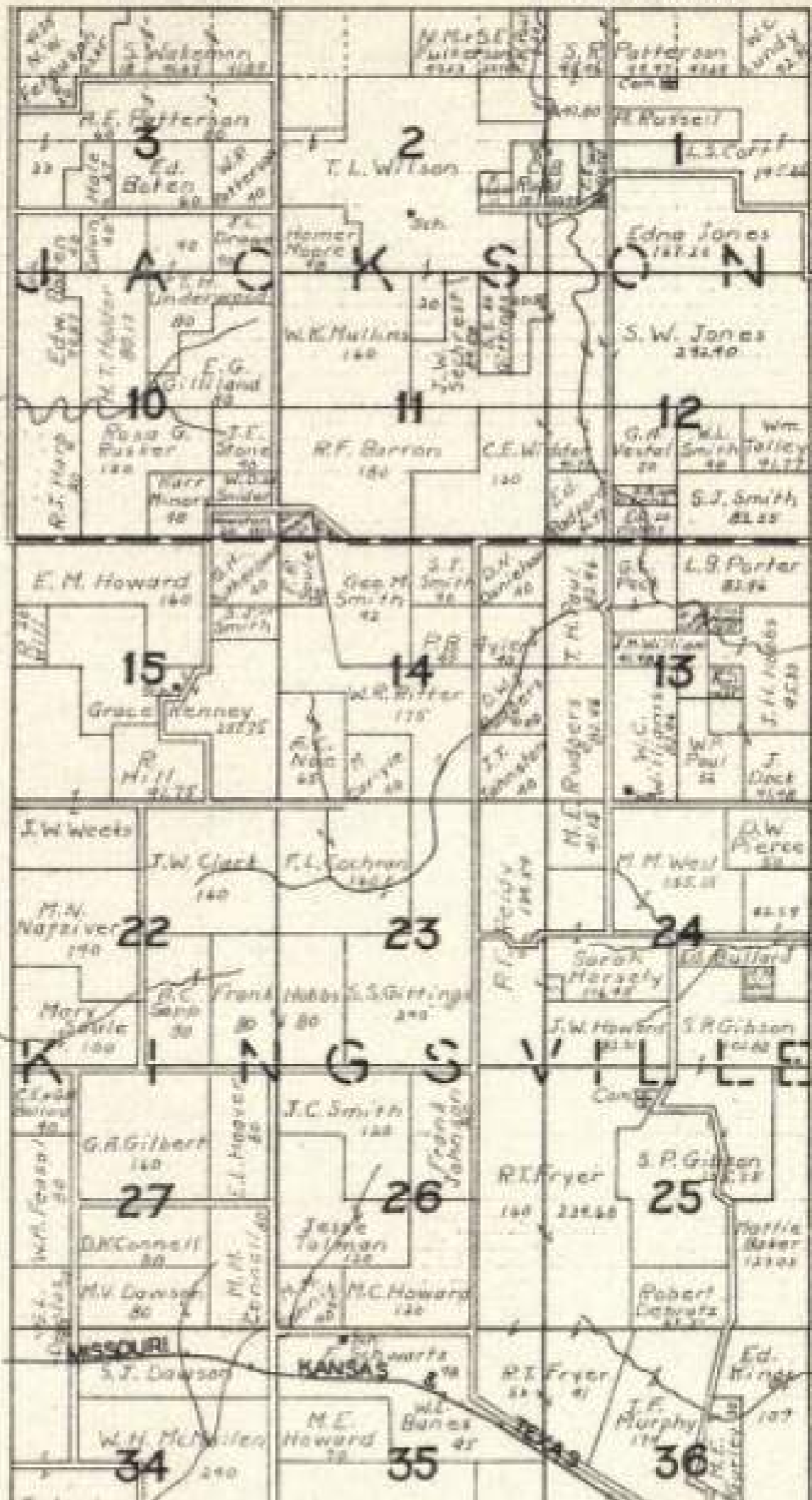

JACKSON

KINGSVILLE

MISSOURI

KANSAS

TEXAS

2
3
10
11
12
13
14
15
22
23
24
25
26
27
34
35
36

S. F. Patterson
Edna Jones
S.W. Jones
R.F. Barron
E.M. Howard
J.W. Weets
J.W. Clark
F.L. Cochran
J.W. Napriver
Mary Seale
G.C. Frank
Frank Hobbs
S.S. Gittings
J.C. Smith
J.E. Hoover
G.A. Gilbert
D.A. Connell
M.V. Dams
S.J. Dawson
W.H. McMillen
M.E. Howard
W.L. Barnes
R.I. Fryer
S.P. Gibson
Robert Roberts
J.F. Murphy
Ed. King

100
120
140
160
180
200
220
240
260
280
300
320
340
360
380
400
420
440
460
480
500
520
540
560
580
600
620
640
660
680
700
720
740
760
780
800
820
840
860
880
900
920
940
960
980
1000

1.47N. PART OF JACKSON R. 29W.

